

SPECIFICATIONS

AEROTECH



Unmatched Flexibility / Legendary Reliability

20' to 25' CUTAWAY BUS



Since 1979 the Aerotech continues to provide the best value for durability and carefree operation in the cutaway market! No matter your transportation need, the Aerotech offers unmatched dependability, safety, floorplan flexibility and hundreds of options.

Our "Aero" line is built using a steel-reinforced composite body construction that is highly resistant to impact, rust and corrosion. Side and rear impact testing demonstrates the durability and strength of the "Aero" body composite construction!



GREAT BRANDING

Your bus is a reflection of your company and brand so you want it to make a good impression. We offer polished paint schemes, full color/photo quality decals, and beautiful upholstery on seats, walls and/or ceilings. We will work with you to outfit your bus just the way you need it!



WORRY-FREE MAINTENANCE

From the floor to the door we have you covered. Unlike other buses our entry door frames, wheel-chair lift door frames and step wells are made with powder coated galvanized steel to ensure these critical, exposed areas will last.



NOT ALL BUSES ARE CREATED EQUAL

We've got you covered no matter your transportation needs. Eldorado National has the versatility to give you the floorplans you need and a large selection of options to meet your specific requirements. Best of all, our products share three key qualities; they are the safest, most reliable and highest value buses on the market.

Eldorado
National® - Kansas



DESIGNED AND BUILT IN THE USA! 

POPULAR FLOORPLANS

(Note: This is only a partial listing of available floorplans. To find a floorplan meeting your exact needs, contact your ElDorado National dealer.)

20' MODEL

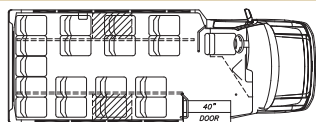

17 Passengers

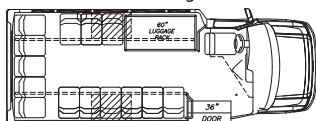

14 Passengers, perimeter seating with 60" Luggage Rack

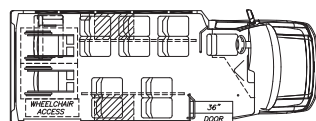

10 Passengers, Rear Lift, 2 Wheelchair positions

22' MODEL

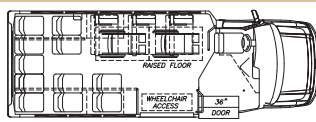

11 Passengers, 2 Wheelchair positions

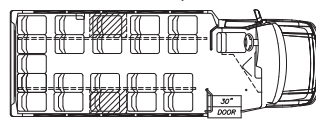

21 Passengers

24' MODEL

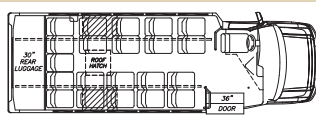

21 Passengers, 30" Rear Luggage

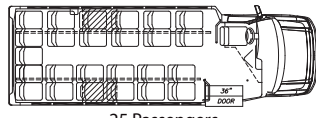

25 Passengers

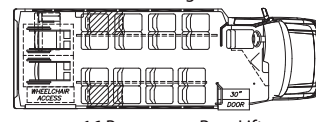

16 Passengers, Rear Lift, 2 Wheelchair positions

25' MODEL



15 Passengers, Front Lift, 2 Wheelchair positions



19 Passengers with 72" Luggage Rack

TECHNICAL SPECIFICATIONS

	20' MODEL	22' MODEL	24' MODEL	25' MODEL
GVWR	11,500 -12,500 lbs.	12,500 -14,050 lbs.	14,500 lbs.	14,500 lbs.
Body Length	21' 7"	23' 2"	24' 8"	25' 1"
Body Width	96"	96"	96"	96"
Wheelbase	138"	158"	176"	186"
Approach Angle (unloaded)	22°	22°-27°	27°	27°
Breakover Angle (unloaded)	15°	15°	15°	15°
Departure Angle (unloaded)	10°	10°	10°	10°
Seating	Up to 17	Up to 21	Up to 25	Up to 25
Body Height	115"			
Interior Height	79" / Flat Floor: 74"			
Entry Door Step Height-Front Standard Floor:	11.5"			
Wheelchair Lift Locations	Front or Rear Doors			
Available Engines	Ford Gas 5.4L V8, 6.8L V10 / Chevy Gas 6.0L V8, Diesel 6.6L V8			
Passenger HVAC	Ranging from 30,000 to 114,000 BTU			
Brakes	ABS Disc Front & Rear			
Tires	LT225/75R16			
Electrical System	EP3			
Suspension	Front Coil Spring/Rear: Leaf Springs			



ElDorado National® - Kansas

1655 Wall Street • Salina, KS 67401
(800) 850-1BUS
www.enconline.com

At ElDorado National, we constantly improve our product. As a result all specifications and dimensions are subject to change without notice.

